



Rosemay Hotel
M.DOGUKAN DASTAN
architecture | interior | furniture

05

ABOUT US

09

CONCEPT

13

PLAN

17

RESTAURANT

23

ROOMS

35

LOBBY

39

CONTACTS

CONTENT



01

ABOUT US



The heart of our design philosophy is the fundamental question how do people actually use space? M.Dogukan Dastan Architecture Office in Istanbul believe that through quality design and development, we can have a greater relationship with the space around us and, ultimately, have a more fulfilling and fulfilled life.

The initial idea to the final drop of creative magic, M.Dogukan Dastan Architect are driven by creativity. It is the core of everything that we do. We are ambitious, devoted and with a global dream. We love to work on projects of all scales in the interconnected fields of urbanism, architecture, and design; from the initial feasibility studies to the final detailing and realization.

02

CONCEPT

Located in London, England, The Rosemay Hotel is a truly remarkable project that we have crafted. It is a hotel like no other, boasting a range of distinctive features. The hotel offers delightfully unique concept suites, each designed to provide a fun and memorable experience. The lobby is creatively designed with playful elements that make it stand out, leaving a lasting impression. Additionally, guests can enjoy a comfortable lounge, a charming café, as well as dedicated spaces for yoga and fitness. The Rosemay Hotel combines elements of fun, creativity, and relaxation to provide a one-of-a-kind experience for its guests.

Our aim for this hotel is to craft a delightful, comfortable, sophisticated, contemporary, and inviting atmosphere. Each area within the hotel embodies its own captivating concept, yet all seamlessly come together to form a cohesive design.

We carefully select diverse and distinctive themes for each room, while maintaining a clean and modern design approach that characterizes these unique suites. The materials used blend harmoniously, creating a cohesive visual experience.

By combining neutral colors with well-placed dark accent tones, we create focal points that enhance the overall elegance of the design.



03

PLAN

Creating an efficient and effective layout design is crucial to optimize the use of space. We meticulously design every area and corner of the hotel, taking into account aesthetics, functionality, and the specific needs of our customers. Our goal is to ensure that every inch of the hotel is carefully planned and designed to provide a seamless and enjoyable experience for our guests.

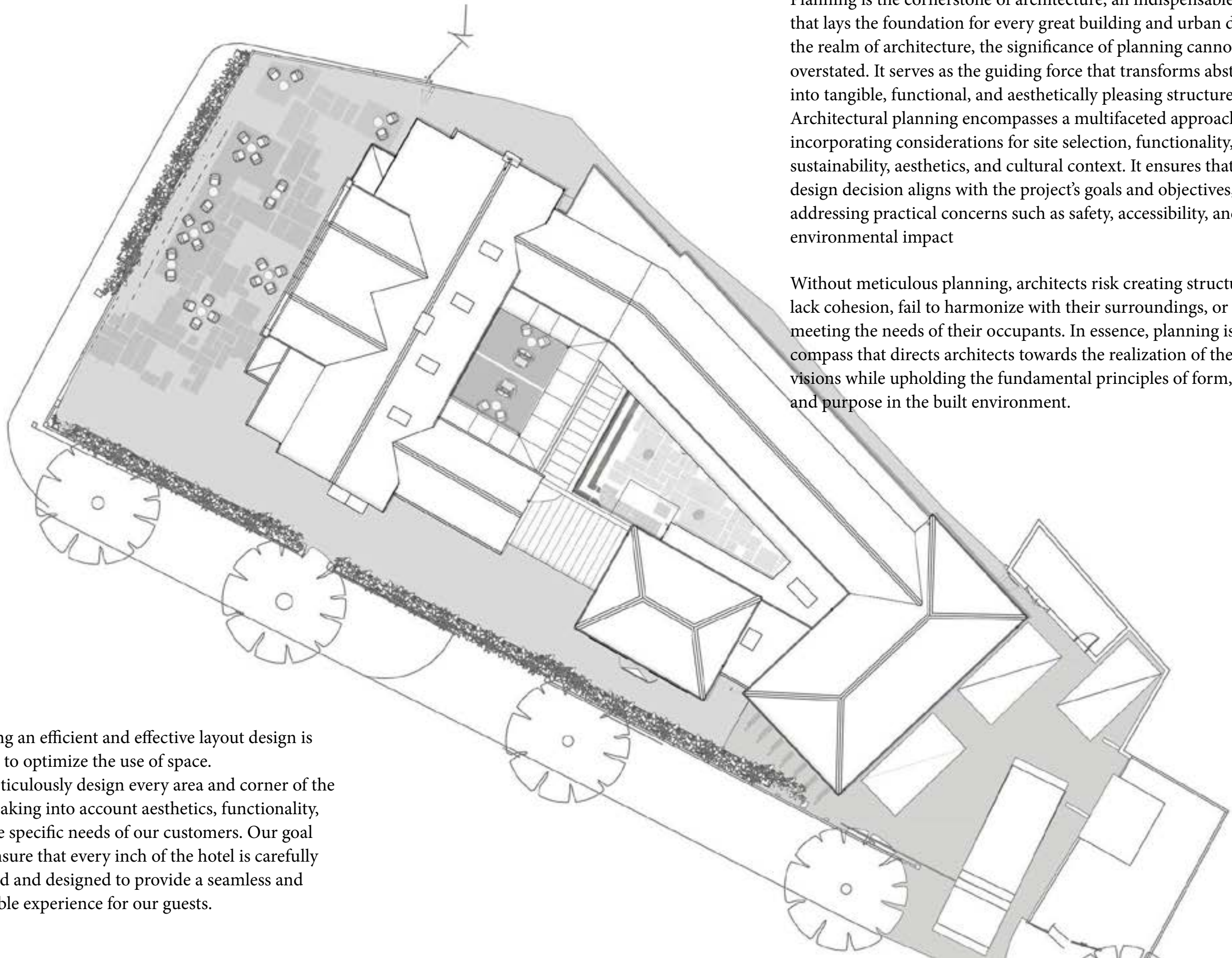

Planning is the cornerstone of architecture, an indispensable process that lays the foundation for every great building and urban design. In the realm of architecture, the significance of planning cannot be overstated. It serves as the guiding force that transforms abstract ideas into tangible, functional, and aesthetically pleasing structures. Architectural planning encompasses a multifaceted approach, incorporating considerations for site selection, functionality, sustainability, aesthetics, and cultural context. It ensures that every design decision aligns with the project's goals and objectives, while also addressing practical concerns such as safety, accessibility, and environmental impact.

Without meticulous planning, architects risk creating structures that lack cohesion, fail to harmonize with their surroundings, or fall short of meeting the needs of their occupants. In essence, planning is the compass that directs architects towards the realization of their creative visions while upholding the fundamental principles of form, function, and purpose in the built environment.

04

RESTAURANT



“

DESIGN
IS MAKING THE
BEST
POSSIBLE USE
OF
THE AVAILABLE
APACE

”





05

ROOMS

COZY SUNSHINE



BLUE BREEZE



VIVID SUNRISE



NATURAL PARADISE



SERENE BOHO



06

LOBBY



Planning is the cornerstone of architecture, an indispensable process that lays the foundation for every great building and urban design. In the realm of architecture, the significance of planning cannot be overstated. It serves as the guiding force that transforms abstract ideas into tangible, functional, and aesthetically pleasing structures. Architectural planning encompasses a multifaceted approach, incorporating considerations for site selection, functionality, sustainability, aesthetics, and cultural context. It ensures that every design decision aligns with the project's goals and objectives, while also addressing practical concerns such as safety, accessibility, and environmental impact



CONTACT

www.mensalupi.com

+902128718916

+90(532) 390 70 66

İzzet Paşa, Yeni Yol Cd. Nuro
Tower Kat:32, No:3206, 34387
Şişli-ISTANBUL, Turkey

BRANCH OFFICE

info@mensalupi.com

+903123531353

DemirhendekCad.No:112Sitel
ANKARA,TURKEY

LONDON OFFICE

116-118 Church Rd,
Hayes UB3 2LW,
London, UK

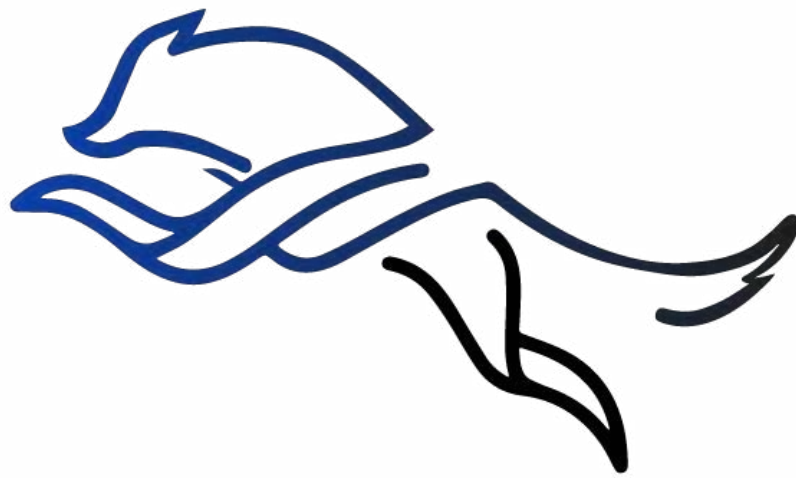

Mensa Lupi